



FICHE TECHNIQUE - TECHNICAL SPECIFICATIONS

4R20-2 - 4R25-2

PRS9001



CARACTERISTIQUES ELECTRIQUES ELECTRICAL CHARACTERISTICS

IEC	4R20-2 / 4R25-2
ANSI	918
Couple chimique/Chemical system	Zinc Chloride
Tension nominale/Nominal Voltage	6V
Capacité nominale/Nominal Capacity	18300mAh (110Ω, 12h/d, 20°C, e.v.:3.6V)
Température de fonctionnement/ Operating Temperature	-20 °C~50 °C
Teneur en métaux lourds/Heavy metal contents	Hg < 1ppm - Cd < 5ppm - Pb <200ppm
Details	Boîtier Plastique/Plastic Casing Vis/Screws

DIMENSIONS

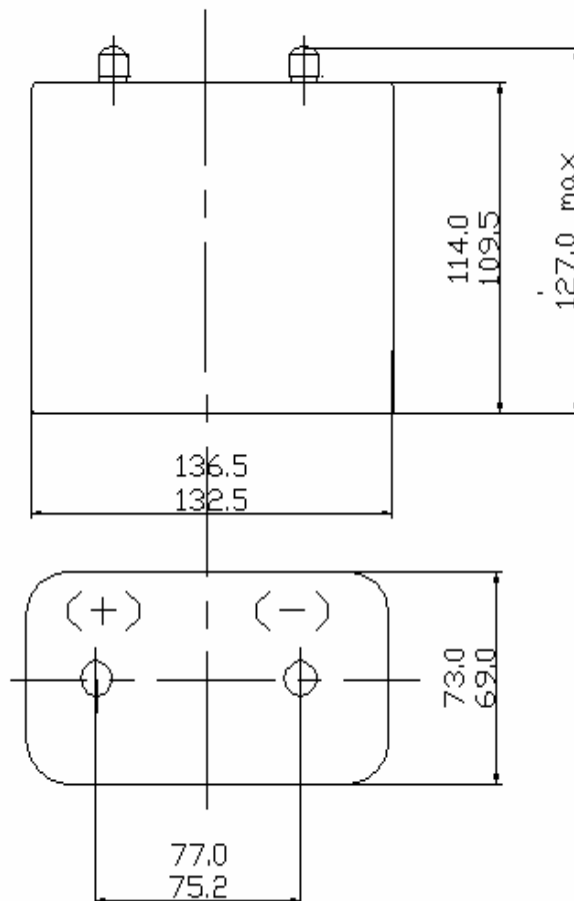

Dimensions en millimètres/in millimeters

Poids/Weight 1150gr

Decharge sur 10 ohms

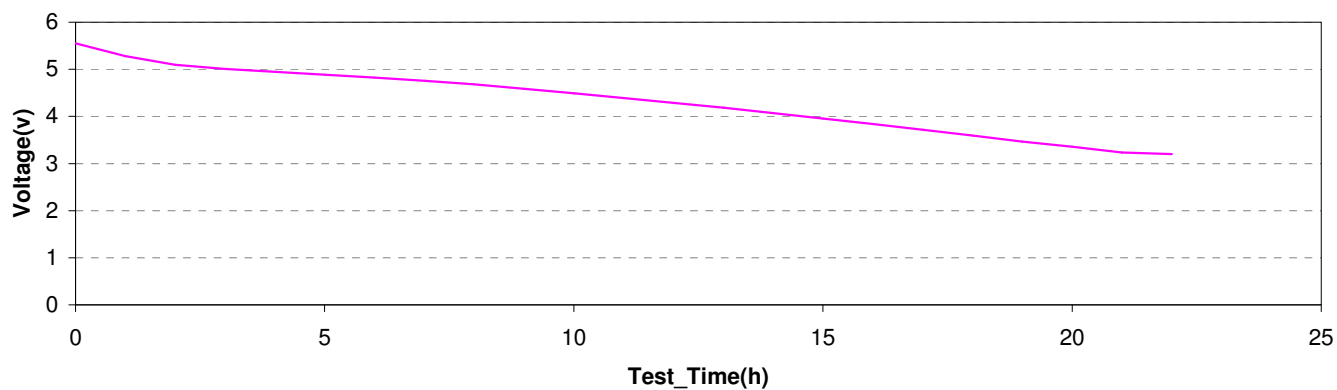

Decharge sur 4.7 ohms

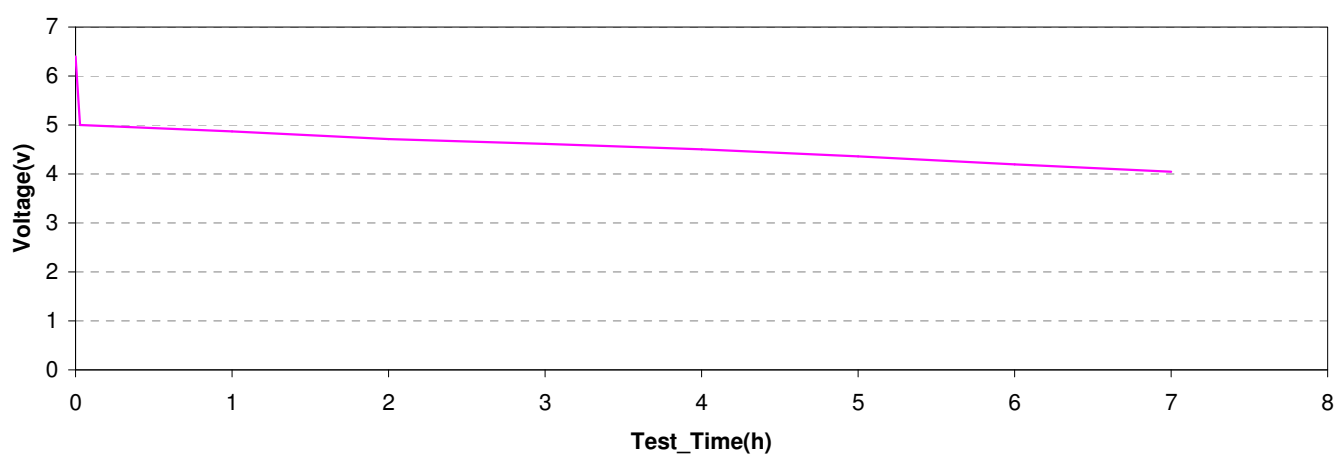

DATE LIMITE D'UTILISATION/EXPIRY PERIOD

Indiqué sur la pile/noted on the battery : 3 ans/years
à une température de stockage de/within a storage temperature of : 10 à/to 25°C